

# Augaflo

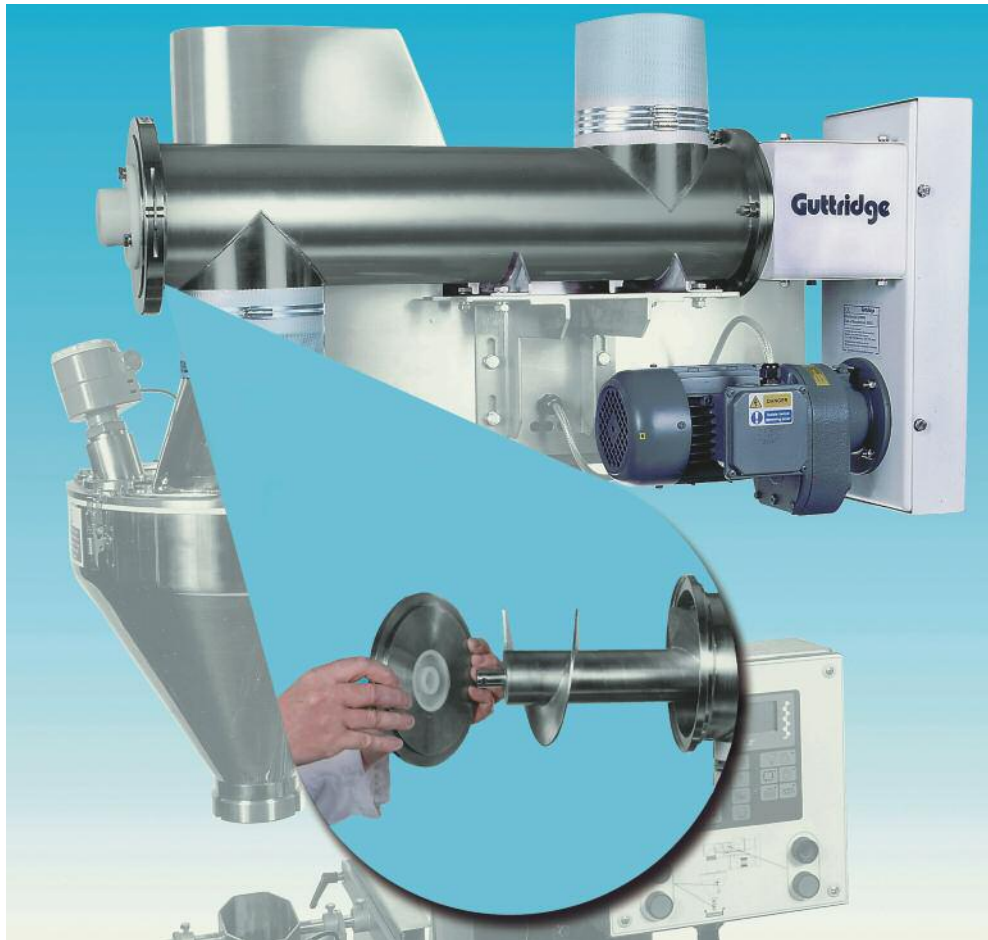

The Guttridge Augaflo is a high quality special purpose cross feed auger designed for use with Auger Filling Machines. By electrically linking the Augaflo to a level probe in the filling machine hopper a more consistent level of material can automatically be maintained in the hopper. With most product types this will usually lead to improved fill accuracy with consequential cost savings.

The machine is designed, in common with all Guttridge machines, with ease of cleaning and maintenance in mind. Rapid release clamp connectors are used to secure the end plates which house a longlife nylon bearing at one end and a pair of conventional flange bearings at the other end. A robust packing gland seal protects the flange bearings against product ingress.

A geared motor with chain drive is used as standard, but other configurations are optionally available. Many of the component parts are interchangeable with other Guttridge conveyor systems for maintenance convenience.

Ideal for handling powders, granules, pellets, flakes and any free flowing materials.

- **Designed specially for use with Auger Filling Machines**
- **Rapid release tube clamps & slip-fit auger for easy clean down**
- **Robust packing gland seal protects bearings from product ingress**
- **316 stainless steel contact parts**
- **Tough powder coated mild steel non-contact parts**
- **Available configured and modified to suit individual specifications**

## Guttridge

**Bulk Materials Handling**

[www.guttridge.com](http://www.guttridge.com)

## Construction

- The Augaflo machine is sturdily constructed, using high quality materials throughout. All components are precision punched and fabricated for ease of assembly and interchangeability.
- All contact parts are manufactured from 316 grade stainless steel, external surfaces polished with a uniform grained finish to 180 grit.
- Non-contact parts are manufactured from mild steel with external surfaces powder coated for maximum durability and long life.
- The drive is from a standard geared motor with a drive chain, selected to suit the required screw speed. Motors are rated to IP55 as standard.
- Conventional flange bearings support the stainless steel drive shaft which rotates in a packing gland seal to provide an effective seal against most types of products.
- The tail shaft runs in a nylon bush ensuring a long trouble free life.

## Operation

- Careful attention has been paid to the design of the Augaflo machine to ensure ease and safety of operation.
- A single Allen key is the only tool necessary for a typical clean-down operation between batches.
- The main tube sections are joined by a special tube clamp which provides a strong and secure joint that can be easily disassembled by undoing a single captive set screw.

- The drive shaft and screw sections are connected using special slip-fit couplings which require no gudgeon bolts making disassembly remarkably quick and easy.
- The Augaflo is designed for horizontal, inclined or vertical use, but this must be specified at the time of enquiry.
- The drive motor mounting is of a unique design, allowing the drive to be positioned above, below or at the side - especially useful where site conditions allow limited space.

## Maintenance

- The Augaflo machine has been designed to be reliable and easy to maintain so that non-productive downtime is kept to a minimum.

## Optional Extras

- Variable pitch flighting, ribbon flighting, crescent blades, etc., are all available to suit particular applications.
- Alternative quick release fittings are available - swing bolt or tri-clover with magnetic interlock switches.
- Direct coupled right angle geared motor drive.
- Hinged swing-away drive mounting.
- Fantail and other specially shaped inlets.
- Stainless steel polished to special requirements.
- Special purpose machines, fabricated entirely to customers' own specifications.

**Our policy is one of continuous improvement, all dimensions and technical details are subject to change without notice. Please check at time of ordering.**

## Augaflo

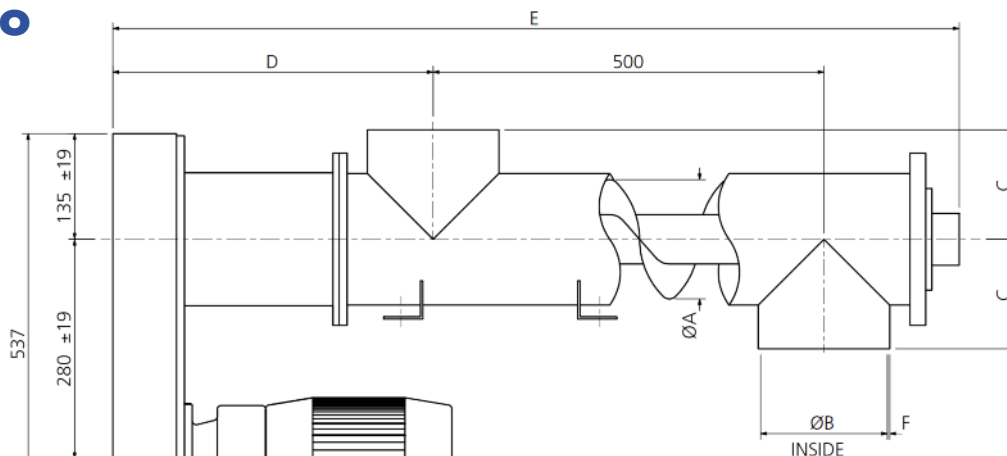

### Principle Dimensions

Conveyor Size	A	B	C	D	E	F
75	76	84.7	110	390	1043	2.1
100	102	110	110	390	1043	2.1
125	127	135.8	125	390	1053	2.8
150	152	162.7	140	410	1083	2.8
200	203	213.5	165	440	1143	2.8

### Notes:

1. Product capacities and flowrates are very dependent on 'flowability', moisture content and density. Please seek technical advice.
2. Dimensions and technical details are subject to change without notice. Please check at time of ordering.

# Guttridge

Guttridge Ltd, Wardentree Park, Spalding,  
Lincolnshire, PE11 3UU, United Kingdom  
Tel: +44 (0) 1775 765300 Email: sales@guttridge.co.uk



## Bulk Materials Handling

[www.guttridge.com](http://www.guttridge.com)